

ASPEN 14-24-000X Miniature Rotary Compressor

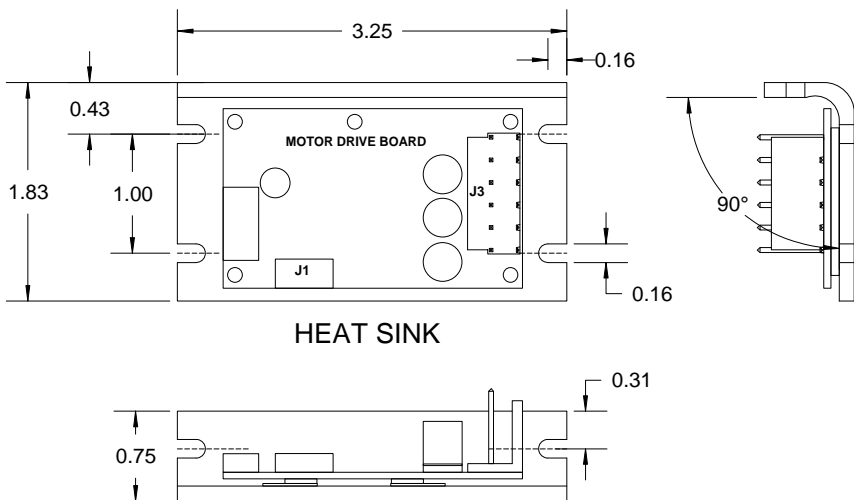

Refrigerant	HFC-134a, R404
Oil Type	POE RL 68H
Oil Quantity	Shipped with Oil (21 cc prior to operating)
Motor	Brushless DC
Voltage	24 VDC (nominal)
Voltage Range	20 – 30 VDC
Max Current	9.5 Amps Continuous
Compressor Displacement	1.4 cc (.085 in ³)
Compressor Speed	Variable
Speed Range	2000 – 6500 RPM
Compressor Weight	1.3 lb (590 g)
Evaporator Temperature Range	0–75°F (-18–24°C)
Condenser Temperature Range	80-160°F (27-71°C)
Max Discharge Temp.	265°F (130°C)
Max Compression Ratio	8:1
Max Compartment Temp.	130°F (54°C)
Suction Port Size	0.32" ID Cup
Discharge Port Size	0.25" OD Tube
Suction/Discharge Tube Orientation	180° Standard Custom Available
Compressor Mounting	User Supplied
Motor Drive Type	Sensorless
Analog Voltage Speed Command (Linear)	0 - .499 VDC = OFF .50 VDC = ~1800 RPM 4.5 VDC = ~6500 RPM
Drive Board Footprint	1.5" x 2.5"
Drive Board Weight	1.0 oz (28 g)
Drive Board Heat Sink	Anodized Aluminum
Heat Sink Footprint	1.83" x 3.25"
Heat Sink Weight	1.4 oz (39 g)

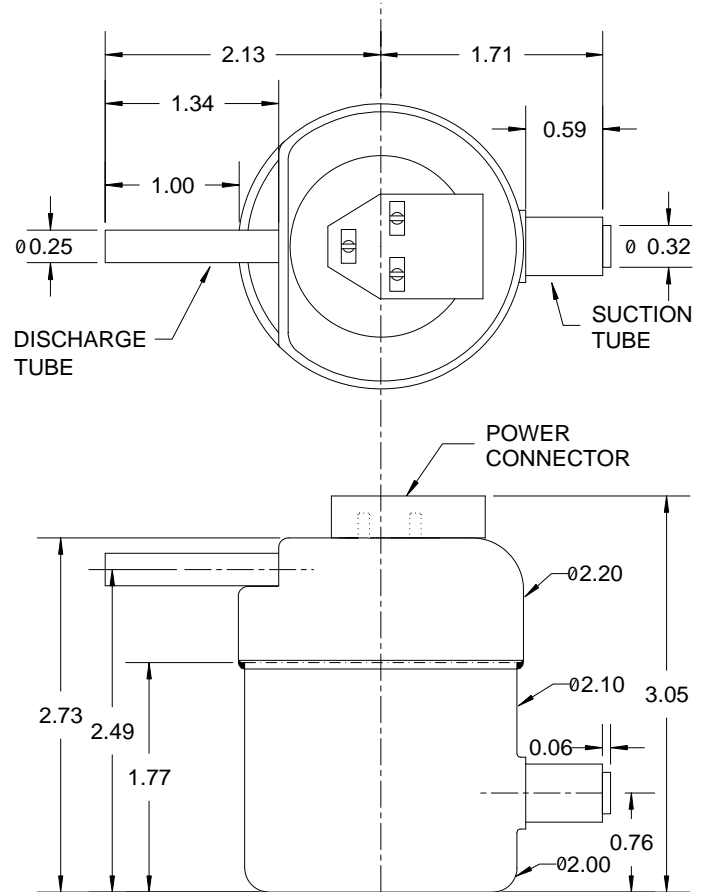

Application Notes:

1. Drive Board must not be subject to corrosive or wet environments. Drive board is thermally protected, however continuous airflow over the drive board and heat sink is recommended.
2. To meet space constraints of many applications the compressor is not supplied with an accumulator. A refrigerant gas filter up stream of the suction port is recommended to prevent damage to the compressor.

A Strainer Element from Refrigeration Research (www.refresearch.com) Part # 161, 162, or 163 with 140 mesh (105 micron) is suitable. to meet space constraints of many applications the compressor is not supplied with an accumulator. A refrigerant gas filter up stream of the suction port is recommended to prevent damage to the compressor.

ASPEN 14-24-000X

ASPEN COMPRESSOR LLC
#ASPEN 14-24-000X
6000 RPM

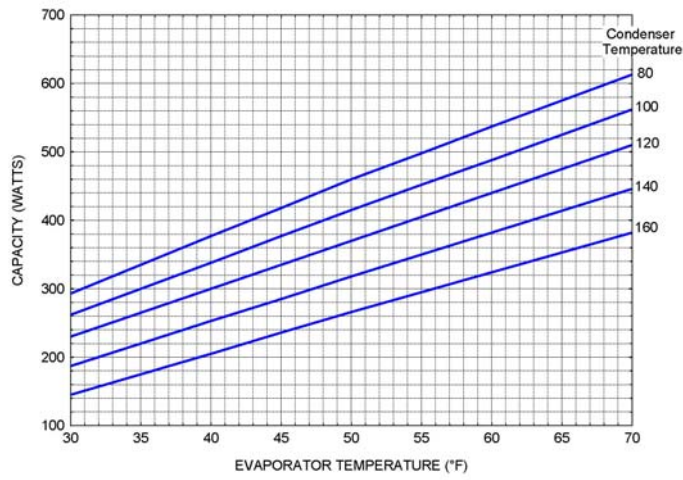

ASPEN COMPRESSOR LLC
#ASPEN 14-24-000X
4500 RPM

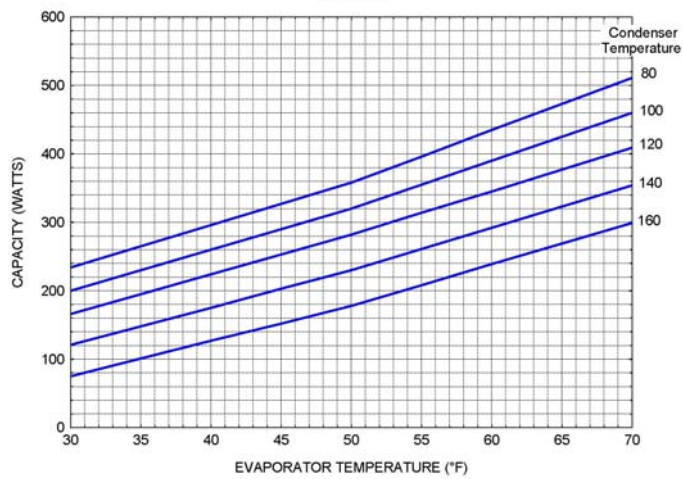

ASPEN COMPRESSOR LLC
#ASPEN 14-24-000X
3000 RPM

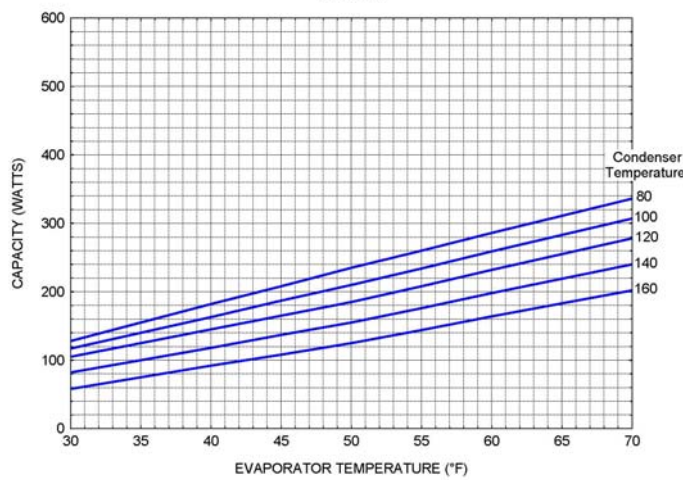

ASPEN 14-24-000X

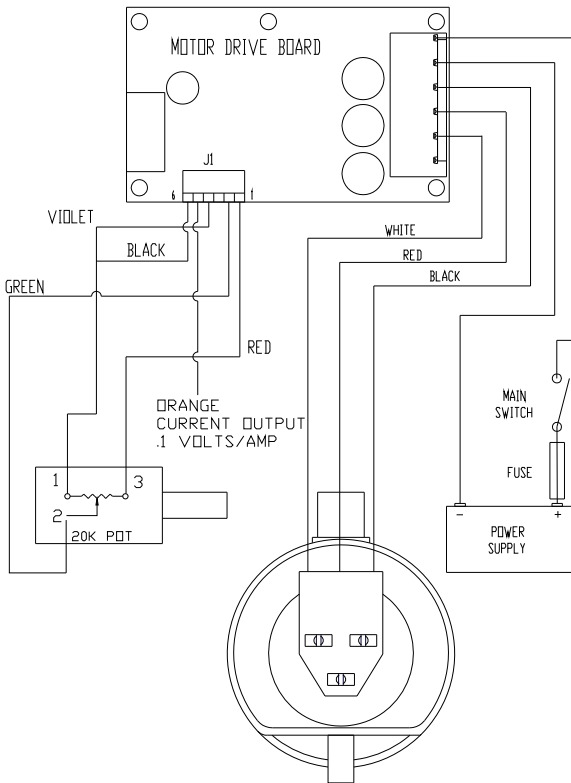

Wiring Option 1 (User supplied potentiometer)

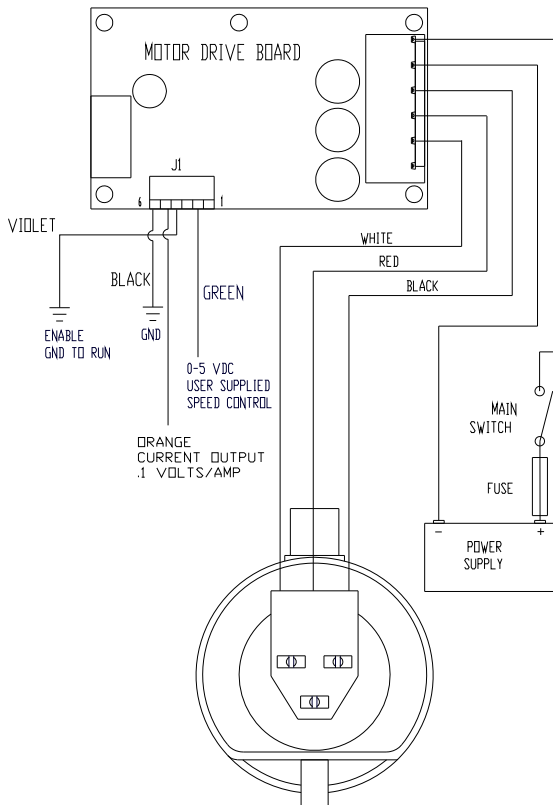

Wiring Option 2 (User supplied speed input voltage)



Exclusive sale by



Termotek AG
Im Rollfeld 6
D 76532 Baden-Baden
Germany
Phone: +49 7221 9711-0
Fax: +49 7221 9711-111
www.termotek-ag.com
info@termotek-ag.com